

VALVES



PIPES



**FITTINGS, FLANGES
GASKETS, FASTENERS**



PACKAGES



ENGINEERING



**GAS AND LIQUID FUELS
SYSTEMS**



OIL & GAS SERVICES since 1958

Pipe fittings according to ANSI B16.9, B16.10, B16.11, B16.25, B16.28, B36.10, MSS-SP-75, MSS-SP-82. Rating up to SCH 160. Size from 1/4" to 60". Carbon steel, alloy steel, steel for low temperature service, stainless steel.

Butt Weld fittings, seamless and welded: LR and SR elbows, LR and SR 180° return bends, equal tees, reduction tees, caps, concentric reducers, eccentric reducers, etc.

Flanged fittings, threaded and socket-weld types: elbows, tees, caps, hex. head plugs, crosses, straight couplings, half couplings, reducing couplings, hex. shoulder nipples, reducing hex. shoulder nipples, straight nipples, swage nipples, M/F reducing fittings, street elbows, unions.

Rating: 3000-6000 Lbs. Size from 1/4" to 4"

Self-reinforcing branch outlet fittings: weldolet, socket, reinforced nipples and flanged outlets. Design ASME B31.1, B31.3, B31.4, B31.8.

Rating up to 6000 Lbs. Size from 1/2" to 36".



Flanges: blind, socket welding, slip-on welding, lap joint, screwed and welding neck type.

Carbon steel, stainless steel and alloys according to ASTM and ISO. Conforming to standards ASME-ANSI B16.5 - B16.47, MSS-SP-44, API 605, BS 1560, BS 10, BS 3293, ISO 7005 and API 6A.

Rating from ANSI 150# to 2500#; from API 1500 to API 20000 (for API 6A). Sizes from 1/2" to 48".

Large diameter and anchor flanges: welding neck, slip-on welding, socket welding. Materials: carbon steel, stainless steel and alloys according to ASTM and ISO. Conforming to design ASA B16.1 - B16.5, BS 3293.

Rating: from ANSI 75# to 300#. Size up to 80"



Metallic and semi-metallic gaskets, also under Flexitallic® license

Spiral Wound, Ring T Joints, Metal-Jacketed, Gland-profile, Metallic Flat, Lens, Delta Ring, Non-spiral Ring, Weld-Ring gaskets in any material and working conditions.

Soft gasket sheets and cut gaskets Flexitallic® or Euroguarco® in synthetic fibres (CSF) Fasit®, expanded flexible graphite Graflex®, filled, modified and expanded PTFE Guaflon® and Sigma®, Thermiculite®.

Flange insulation set

Normally including bakelite sleeves and washers, flat ring gaskets in PTFE or Fasit®, steel washers, nuts and bolts.

Gland packings - Sirpack®

Fasteners, bolts and nuts in all dimensions and materials

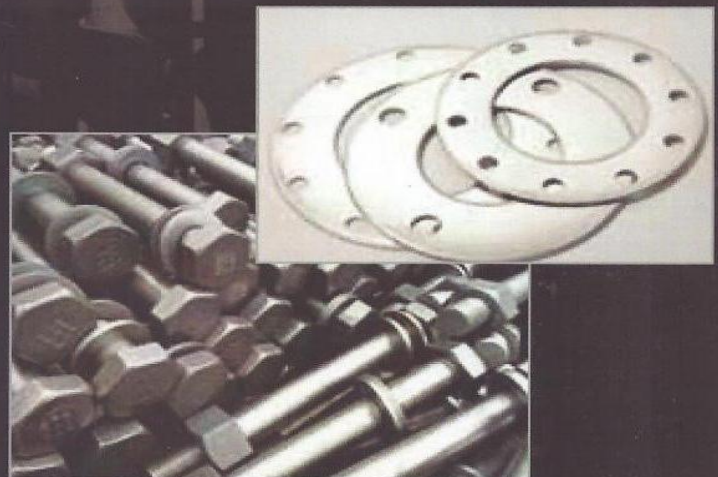

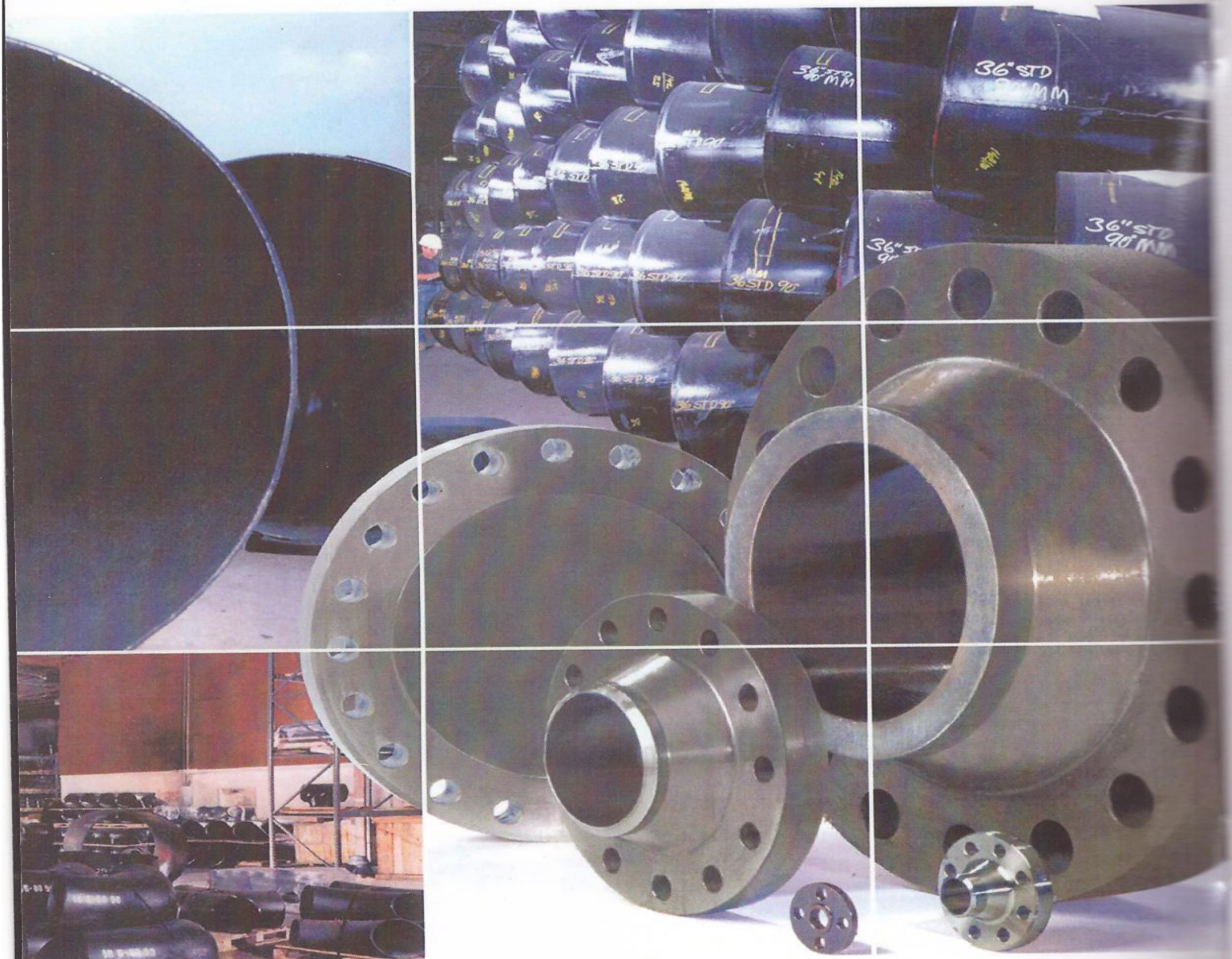

FLANGES & FITTINGS

EUROGUARCO offer the following 'one-stop shopping' service over a complete range of flanges and fittings:

- Flanges, all types: blind, socket welding, slip-on welding, lap joint, screwed and welding neck type. Materials: carbon steel, stainless steel and alloys. Conforming to standards ASME.ANSI B16.5 - B16.47, MSS-SP-44, API 605, BS 1560, BS 10, BS 3293, API 6A, ISO 7005. Sizes from 1/2" to 42". Supplied with EN 10204 3.1B certificate.

- Large diameter flanges (up to 96"): welding neck, slip-on welding, socket welding. Materials: carbon steel, stainless steel and alloys. Conforming to design standards ASA B16.1 - B16.5, BS 3293. Sizes from 1/2" to 48". Supplied with EN 10204 3.1B certificate.

Butt weld pipe fittings, seamless and welded: LR or SR 45° elbows, LR or SR 90° elbows, LR or SR 180° return bends, equal tees, caps, reduction tees, concentric reducers, eccentric reducers. Conforming to standards ANSI B16.9 - 816.25 - 816.28, MSS-SP75.

Materials: carbon steel, stainless steel, alloys and special alloys. Supplied with EN 10204 3.1B certificate.

Forged fittings: threaded and socket-weld fittings: elbows, tees, caps, hex. head plugs, crosses, straight couplings, half couplings, reducing couplings, hex. shoulder nipples, reducing hex. shoulder nipples, straight nipples, swage nipples, M/F reducing bushings, street elbows, unions. Conforming to standards ANSI B16.11 - B36.10 - BS 3799, MSS-SP83. Supplied with EN 10204 3.1B certificate.

Self-reinforcing branch outlets (weldolets): threaded, socket-weld and butt-weld branch outlets, reinforced nipples and flanged outlets. Codes: ASME 831.1 - 831.3 - 831.4 - 831.8. Conforming to standards ANSI 816.11 - 836.10 - BS 3799, MSS-SP83. Supplied with EN 10204 3.1B certificate.

for further details feel free to contact our technical staff at
(+39) 0187562611 - fax (+ 39) 0187562644 - 562955
info@euroguarco.com

 **EUROGUARCO**

Euroguarco S.p.A.

Loc. Pietralba di Arcola, 19021 La Spezia, Italy
Tel. + 39 0187 562611 Fax + 39 0187 562644 - 562955
e-mail: info@euroguarco.com - www.euroguarco.com





Diametro Size		O	A	C	Y	X	R	Foratura Drilling			Peso Weight
DN	NPS	mm	mm	mm	mm	mm	mm	Numero Number	d mm	G mm	Kg
15	1/2	90	22	11,5	16	30	34,9	4	16	60,5	0,4
20	3/4	100	28	13,0	16	38	42,9	4	16	70,0	0,7
25	1	110	34,5	14,5	17	49	50,8	4	16	79,5	0,8
32	1 1/4	120	43,5	16,0	21	59	63,5	4	16	89,0	1,1
40	1 1/2	130	49,5	17,5	22	65	73,0	4	16	98,5	1,4
50	2	150	62	19,5	25	78	92,1	4	20	120,5	2,2
65	2 1/2	180	74,5	22,5	29	90	104,8	4	20	139,5	3,6
80	3	190	90,5	24,0	30	108	127,0	4	20	152,5	4,1
-	3 1/2	215	103,5	24,0	32	122	139,7	8	20	178,0	5,2
100	4	230	116	24,0	33	135	157,2	8	20	190,5	5,6
125	5	255	143,5	24,0	36	164	185,7	8	22	216,0	6,3
150	6	280	170,5	25,5	40	192	215,9	8	22	241,5	7,5
200	8	345	221,5	29,0	44	246	269,9	8	22	298,5	12,6
250	10	405	276	30,5	49	305	323,8	12	26	362,0	18,5
300	12	485	327	32,0	56	365	381,0	12	26	432,0	28
350	14	535	359	35,0	57	400	412,8	12	30	476,0	38
400	16	600	410,5	37,0	64	457	469,0	16	30	540,0	46
450	18	635	462	40,0	68	505	533,4	16	33	578,0	50
500	20	700	513	43,0	73	559	584,2	20	33	635,0	64
600	24	815	616	48,0	83	664	692,2	20	36	749,5	89

Slip on class 150 raised face

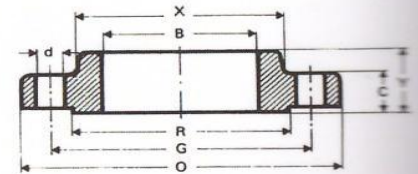

DN 15 a 600
NPS 1/2 to 24
ANSI B 16-5

Diametro Size		O	A	C	Y	X	R	Foratura Drilling			Peso Weight
DN	NPS	mm	mm	mm	mm	mm	mm	Numero Number	d mm	G mm	Kg
15	1/2	95	22	14,5	22	38	34,9	4	16	66,5	0,7
20	3/4	120	28	16,0	25	48	42,9	4	20	82,5	1,1
25	1	125	34,5	17,5	27	54	50,8	4	20	89,0	1,4
32	1 1/4	135	43,5	19,5	27	64	63,5	4	20	98,5	1,8
40	1 1/2	155	49,5	21,0	30	70	73,0	4	22	114,5	2,6
50	2	165	62	22,5	33	84	92,1	8	20	127,0	3,4
65	2 1/2	190	74,5	25,5	38	100	104,8	8	22	149,0	4,4
80	3	210	90,5	29,0	43	118	127,0	8	22	168,5	6,1
-	3 1/2	230	103,5	30,5	44	133	139,7	8	22	184,0	7,5
100	4	255	116	32,0	48	146	157,2	8	22	200,0	10,1
125	5	280	143,5	35,0	51	178	185,7	8	22	235,0	12,5
150	6	320	170,5	37,0	52	206	215,9	12	22	270,0	14,1
200	8	380	221,5	41,5	62	260	269,9	12	26	330,0	24,9
250	10	445	276	48,0	67	321	323,8	16	30	387,5	37,1
300	12	520	327	51,0	73	375	381,0	16	33	451,0	50
350	14	585	359	54,0	76	426	412,8	20	33	514,5	70
400	16	650	410,5	57,5	83	483	469,9	20	36	571,5	97
450	18	715	462	60,5	89	533	533,4	24	36	628,5	123
500	20	775	513	63,5	95	587	584,2	24	36	686,0	133
600	24	915	616	70,0	106	702	692,2	24	42	813,0	208

Slip on class 300 raised face

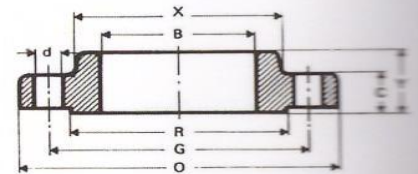

DN 15 a 600
NPS 1/2 to 24
ANSI B 16-5

FLANGES

Slip on class 600 raised face

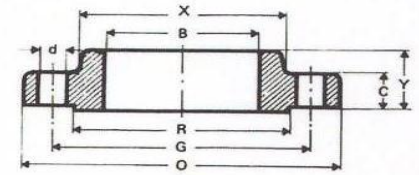

DN 15 a 600
NPS 1/2 to 24

ANSI B 16-5

Diametro Size		O	A	C	Y	X	R	Foratura Drilling			Peso Weight
DN	NPS	mm	mm	mm	mm	mm	mm	Numero Number	d mm	G mm	Kg
15	1/2	95	22	14,5	22	38	34,9	4	16	66,5	0,8
20	3/4	120	28	16,0	25	48	42,9	4	20	82,5	1,4
25	1	125	34,5	17,5	27	54	50,8	4	20	89,0	1,6
32	1 1/4	135	43,5	21,0	29	64	63,5	4	20	98,5	2,1
40	1 1/2	155	49,5	22,5	32	70	73,0	4	22	114,5	3,1
50	2	165	62	25,5	37	84	92,1	8	20	127,0	3,7
65	2 1/2	190	74,5	29,0	41	100	104,8	8	22	149,0	5,4
80	3	210	90,5	32,0	46	117	127,0	8	22	168,5	7,3
-	3 1/2	230	103,5	35,0	49	133	139,7	8	26	184,0	8,9
100	4	275	116	38,5	54	152	157,2	8	26	216,0	15,8
125	5	330	143,5	44,5	60	189	185,7	8	30	267,0	24,5
150	6	355	170,5	48,0	67	222	215,9	12	30	292,0	29,5
200	8	420	221,5	55,5	76	273	269,9	12	33	349,0	43
250	10	510	276	63,5	86	343	323,8	16	36	432,0	70
300	12	560	327	66,5	92	400	381,0	20	36	489,0	86
350	14	605	359	70,0	94	432	412,8	20	39	527,0	100
400	16	685	410,5	76,5	106	495	469,9	20	42	603,0	142
450	18	745	462	83,0	117	546	533,4	20	45	654,0	175
500	20	815	513	89,0	127	610	584,2	24	45	724,0	221
600	24	940	616	102,0	140	718	692,2	24	52	838,0	315

Slip on class 900 raised face

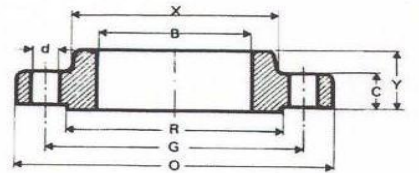

DN 15 a 600
NPS 1/2 to 24

ANSI B 16-5

Diametro Size		O	A	C	Y	X	R	Foratura Drilling			Peso Weight
DN	NPS	mm	mm	mm	mm	mm	mm	Numero Number	d mm	G mm	Kg
15	1/2	120	22	22,5	32	38	34,9	4	22	82,5	1,7
20	3/4	130	28	25,5	35	44	42,9	4	22	89,0	2,3
25	1	150	34,5	29,0	41	52	50,8	4	26	101,5	3,4
32	1 1/4	160	43,5	29,0	41	64	63,5	4	26	111,0	3,9
40	1 1/2	180	49,5	32,0	44	70	73,0	4	30	124,0	5,4
50	2	215	62	38,5	57	105	92,1	8	26	165,0	9,8
65	2 1/2	245	74,5	41,5	64	124	104,8	8	30	190,5	13,7
80	3	240	90,5	38,5	54	127	127,0	8	26	190,5	11,6
100	4	295	116	44,5	70	159	157,2	8	33	235,0	19,8
125	5	350	143,5	51,0	79	190	185,7	8	36	279,5	32
150	6	380	170,5	56,0	86	235	215,9	12	33	317,5	41,2
200	8	470	221,5	63,5	102	298	269,9	12	39	393,5	71
250	10	545	276	70,0	108	368	323,8	16	39	470,0	100
300	12	610	327	79,5	117	419	381,0	20	39	533,5	133
350	14	640	359	86,0	130	451	412,8	20	42	559,0	152
400	16	705	410,5	89,0	133	508	469,9	20	45	616,0	184
450	18	785	462	102,0	152	565	533,4	20	52	686,0	258
500	20	855	513	108,8	159	622	584,2	20	56	749,5	317
600	24	1040	616	140,0	203	749	692,2	20	68	901,5	608

Slip on class 1500 raised face

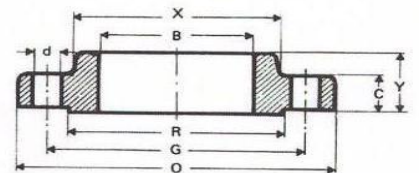

DN 15 a 65
NPS 1/2 to 2 1/2

ANSI B 16-5

Diametro Size		O	B min	C	Y	X	R	Foratura Drilling			Peso Weight
DN	NPS	mm	mm	mm	mm	mm	mm	Numero Number	d mm	G mm	Kg
15	1/2	120	22	22,5	32	38	34,9	4	22	82,5	1,7
20	3/4	130	28	25,5	35	44	42,9	4	22	89,0	2,3
25	1	150	34,5	29,0	41	52	50,8	4	26	101,5	3,4
32	1 1/4	160	43,5	29,0	41	64	63,5	4	26	111,0	3,9
40	1 1/2	180	49,5	32,0	44	70	73,0	4	30	124,0	5,4
50	2	215	62	38,5	57	105	92,1	8	26	165,0	9,8
65	2 1/2	245	74,5	41,5	64	124	104,8	8	30	190,5	13,7

Diametro Size		O	A	C	Y	X	R	Foratura Drilling			Peso Weight
DN	NPS	mm	mm	mm	mm	mm	mm	Numero Number	d mm	G mm	Kg
15	1/2	90	21,5	11,5	48	30	34,9	4	16	60,5	0,5
20	3/4	100	26,5	13,0	52	38	42,9	4	16	70,0	0,7
25	1	110	33,5	14,5	56	49	50,8	4	16	79,5	1,1
32	1 1/4	120	42	16,0	57	59	63,5	4	16	89,0	1,5
40	1 1/2	130	48,5	17,5	62	65	73,0	4	16	98,5	1,8
50	2	150	60,5	19,5	64	78	92,1	4	20	120,5	2,7
65	2 1/2	180	73	22,5	70	90	104,8	4	20	139,5	4,4
80	3	190	89	24,0	70	108	127,0	4	20	152,5	5,2
-	3 1/2	215	101,5	24,0	71	122	139,7	8	20	178,0	6,4
100	4	230	114,5	24,0	76	135	157,2	8	20	190,5	7,5
125	5	255	141,5	24,0	89	164	185,7	8	22	216,0	9,2
150	6	280	168,5	25,5	89	192	215,9	8	22	241,5	11
200	8	345	219	29,0	102	246	269,9	8	22	298,5	18,3
250	10	405	273	30,5	102	305	323,8	12	26	362,0	25
300	12	485	324	32,0	114	365	381,0	12	26	432,0	39
350	14	535	355,5	35,0	127	400	412,8	12	30	476,0	51
400	16	600	406,5	37,0	127	457	469,9	16	30	540,0	60
450	18	635	457	40,0	140	505	533,4	16	33	578,0	71
500	20	700	508	43,0	145	559	584,2	20	33	635,0	88
600	24	815	609,5	48,0	152	664	692,2	20	36	749,5	119

Welding neck class 150 raised face

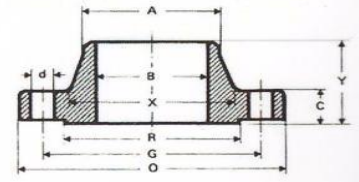

DN 15 a 600
NPS 1/2 to 24
ANSI B 16-5

Diametro Size		O	A	C	Y	X	R	Foratura Drilling			Peso Weight
DN	NPS	mm	mm	mm	mm	mm	mm	Numero Number	d mm	G mm	Kg
15	1/2	95	21,5	14,5	52	38	34,9	4	16	66,5	0,8
20	3/4	120	26,5	16,0	57	48	42,9	4	20	82,5	1,3
25	1	125	33,5	17,5	62	54	50,8	4	20	89,0	1,7
32	1 1/4	135	42	19,5	65	64	63,5	4	20	98,5	2,2
40	1 1/2	155	48,5	21,0	68	70	73,0	4	22	114,5	3,2
50	2	165	60,5	22,5	70	84	92,1	8	20	127,0	3,6
65	2 1/2	190	73	25,5	76	100	104,8	8	22	149,0	5,4
80	3	210	89	29,0	79	118	127,0	8	22	168,5	7,4
-	3 1/2	230	101,5	30,5	81	133	139,7	8	22	184,0	8,9
100	4	255	114,5	32,0	86	146	157,2	8	22	200,0	11,9
125	5	280	141,5	35,0	98	178	185,7	8	22	235,0	16
150	6	320	168,5	37,0	98	206	215,9	12	22	270,0	20
200	8	380	219	41,5	111	260	269,9	12	26	330,0	31
250	10	445	273	48,0	117	321	323,8	16	30	387,5	44
300	12	520	324	51,0	130	375	381,0	16	33	451,0	54
350	14	585	355,5	54,0	143	426	412,8	20	33	514,5	88
400	16	650	406,5	57,5	146	483	469,9	20	36	571,5	113
450	18	715	457	60,5	159	533	533,4	24	36	628,5	134
500	20	775	508	63,5	162	587	584,2	24	36	686,0	171
600	24	915	609,5	70,0	168	702	692,2	24	42	813,0	238

Welding neck class 300 raised face

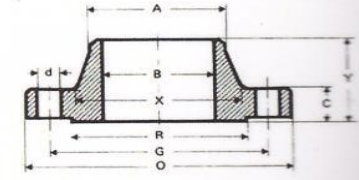

DN 15 a 600
NPS 1/2 to 24
ANSI B 16-5

Diametro Size		O	A	C	Y	X	R	Foratura Drilling			Peso Weight
DN	NPS	mm	mm	mm	mm	mm	mm	Numero Number	d mm	G mm	Kg
15	1/2	95	21,5	14,5	52	38	34,9	4	16	66,5	0,9
20	3/4	120	26,5	16,0	57	48	42,9	4	20	82,5	1,5
25	1	125	33,5	17,5	62	54	50,8	4	20	89,0	1,9
32	1 1/4	135	42	21,0	67	64	63,5	4	20	98,5	2,6
40	1 1/2	155	48,5	22,5	70	70	73,0	4	22	114,5	3,3
50	2	165	60,5	25,5	73	84	92,1	8	20	127,0	4,7
65	2 1/2	190	73	29,0	79	100	104,8	8	22	149,0	6,5
80	3	210	89	32,0	83	117	127,0	8	22	168,5	8,7
-	3 1/2	230	101,5	35,0	86	133	139,7	8	26	184,0	11,2
100	4	275	114,5	38,5	102	152	157,2	8	26	216,0	18,1
125	5	330	141,5	44,5	114	189	185,7	8	30	267,0	30
150	6	355	168,5	48,0	117	222	215,9	12	30	292,0	36
200	8	420	219	55,5	133	273	269,9	12	33	349,0	50
250	10	510	273	63,5	152	343	323,8	16	36	432,0	90
300	12	560	324	66,5	156	400	381,0	20	36	489,0	110
350	14	605	355,5	70,0	165	432	412,8	20	39	527,0	150
400	16	685	406,5	76,5	178	495	469,9	20	42	603,0	190
450	18	745	457	83,0	184	546	533,4	20	45	654,0	240
500	20	815	508	89,0	190	610	584,2	24	45	724,0	295
600	24	940	609,5	102,0	203	718	692,2	24	52	838,0	365

Welding neck class 600 raised face

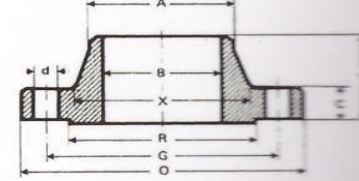

DN 15 a 600
NPS 1/2 to 24
ANSI B 16-5

FLANGES

Welding neck class 900 raised face

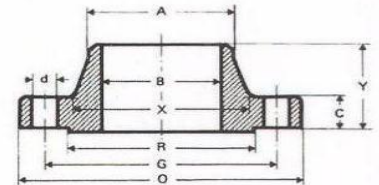

DN 15 a 600
NPS 1/2 to 24

ANSI B 16-5

Diámetro Nominal	D	A	C	Y	X	R	Foratura Drilling			Peso Weight
							Numero Number	d mm	G mm	
15	130	21,5	22,5	60	38	34,9	4	22	82,5	1,9
20	130	26,5	25,5	70	44	42,9	4	22	89,0	2,6
25	130	33,5	29,0	73	52	50,8	4	26	101,5	3,8
30	130	42	29,0	73	64	63,5	4	26	111,0	4,4
40	130	48,5	32,0	83	70	73,0	4	30	124,0	6,1
50	210	80,5	38,5	102	105	92,1	8	26	165,0	11,1
60	210	73	41,5	105	124	104,8	8	30	190,5	15,5
75	210	89	38,5	102	127	127,0	8	26	190,5	14
90	210	114,5	44,5	114	159	157,2	8	33	235,0	23
100	210	141,5	51,0	127	190	185,7	8	36	279,5	37
125	300	188,5	56,0	140	235	215,9	12	33	317,5	49
150	400	219	63,5	162	298	269,9	12	39	393,5	84
175	540	273	70,0	184	368	323,8	16	39	470,0	123
200	610	324	79,5	200	419	381,0	20	39	533,5	163
225	690	355,5	86,0	213	451	412,8	20	42	559,0	186
250	730	406,5	89,0	216	508	469,9	20	45	616,0	224
275	780	457	102,0	229	565	533,4	20	52	686,0	30
300	825	508	108,0	248	622	584,2	20	56	749,5	37,3
350	1040	628,5	140,0	292	749	692,2	20	68	901,5	68,0

Welding neck class 1500 raised face

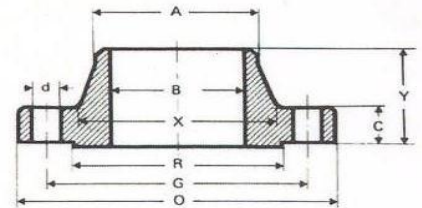

DN 15 a 600
NPS 1/2 to 24

ANSI B 16-5

Diámetro Nominal	D	A	C	Y	X	R	Foratura Drilling			Peso Weight
							Numero Number	d mm	G mm	
15	130	21,5	22,5	60	38	34,9	4	22	82,5	1,9
20	130	26,5	25,5	70	44	42,9	4	22	89,0	2,6
25	130	33,5	29,0	73	52	50,8	4	26	101,5	3,8
30	130	42	29,0	73	64	63,5	4	26	111,0	4,4
40	130	48,5	32,0	83	70	73,0	4	30	124,0	6,1
50	210	80,5	38,5	102	105	92,1	8	26	165,0	11,1
60	210	73	41,5	105	124	104,8	8	30	190,5	15,5
75	210	89	48,0	118	133	127,0	8	33	203,0	20,5
90	210	114,5	54,0	124	165	157,2	8	36	241,5	30,5
100	210	141,5	73,5	155	197	185,7	8	42	292,0	58
125	300	188,5	83,0	171	229	215,9	12	39	317,5	70
150	400	219	92,0	213	292	269,9	12	45	393,5	119
175	540	273	108,0	254	368	323,8	12	52	482,5	204
200	610	324	124,0	283	451	381,0	16	56	571,5	303
225	690	355,5	133,5	298	495	412,8	16	60	635,0	400
250	730	406,5	146,5	311	552	469,9	16	68	705,0	510
275	780	457	162,0	327	507	533,4	16	76	774,5	
300	825	508	178,0	356	641	584,2	16	80	832,0	
350	1070	610	203,5	406	762	692,2	16	94	990,5	

Welding neck class 2500 raised face

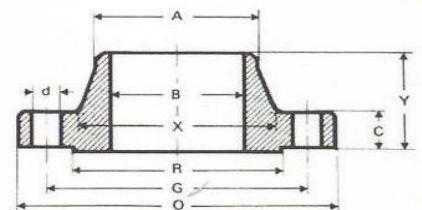

DN 15 a 300
NPS 1/2 to 12

ANSI B 16-5

Diámetro Nominal	D	A	C	Y	X	R	Foratura Drilling			Peso Weight
							Numero Number	d mm	G mm	
15	135	21,5	30,5	73	43	34,9	4	22	89,0	3,6
20	140	26,5	32,0	79	51	42,9	4	22	95,0	4
25	160	33,5	35,0	89	57	50,8	4	26	108,0	6
30	185	42	38,5	95	73	63,5	4	30	130,0	9
40	205	48,5	44,5	111	79	73,0	4	33	146,0	13
50	235	60,5	51,0	127	95	92,1	8	30	171,5	19
60	270	73	57,5	143	114	104,8	8	33	197,0	24
75	305	89	67,0	168	133	127,0	8	36	228,5	43
90	355	114,5	76,5	190	165	157,2	8	42	273,0	66
100	400	141,5	92,5	229	203	185,7	8	48	324,0	111
125	485	168,5	108,0	273	235	215,9	8	56	368,5	172
150	550	219	127,0	318	305	269,9	12	56	438,0	261
175	675	273	165,5	419	375	323,8	12	68	539,5	485
200	780	324	184,5	464	441	381,0	12	76	619,0	730

FLANGES

Diametro Size		O	C	R	Foratura Drilling			Peso Weight
DN	NPS	mm	mm	mm	Numero Number	d mm	G mm	Kg
15	1/2	90	11,5	34,9	4	16	60,5	0,4
20	3/4	100	13,0	42,9	4	16	70,0	0,7
25	1	110	14,5	50,8	4	16	79,5	0,9
32	1 1/4	120	16,0	63,5	4	16	89,0	1,3
40	1 1/2	130	17,5	73,0	4	16	98,5	1,6
50	2	150	19,5	92,1	4	20	120,5	2,6
65	2 1/2	180	22,5	104,8	4	20	139,5	4,1
80	3	190	24,0	127,0	4	20	152,5	5
-	3 1/2	215	24,0	139,7	8	20	178,0	6,4
100	4	230	24,0	157,2	8	20	190,5	7,1
125	5	255	24,0	185,7	8	22	216,0	9
150	6	280	25,5	215,9	8	22	241,5	12
200	8	345	29,0	269,9	8	22	298,5	21
250	10	405	30,5	323,8	12	26	362,0	30
300	12	485	32,0	381,0	12	26	432,0	45
350	14	535	35,0	412,8	12	30	476,0	59
400	16	600	37,0	469,9	16	30	540,0	79
450	18	635	40,0	533,4	16	33	578,0	97
500	20	700	43,0	584,2	20	33	635,0	124
600	24	815	48,0	692,2	20	36	749,5	188

Blind class 150 raised face

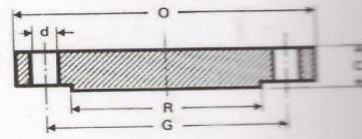

DN 15 a 600
NPS 1/2 to 24

ANSI B 16-5

Diametro Size		O	C	R	Foratura Drilling			Peso Weight
DN	NPS	mm	mm	mm	Numero Number	d mm	G mm	Kg
15	1/2	95	14,5	34,9	4	16	66,5	0,7
20	3/4	120	16,0	42,9	4	20	82,5	1,2
25	1	125	17,5	50,8	4	20	89,0	1,5
32	1 1/4	135	19,5	63,5	4	20	98,5	2
40	1 1/2	155	21,0	73,0	4	22	114,5	2,9
50	2	165	22,5	92,1	8	20	127,0	3,4
65	2 1/2	190	25,5	104,8	8	22	149,0	5,1
80	3	210	29,0	127,0	8	22	168,5	7
-	3 1/2	230	30,5	139,7	8	22	184,0	8,9
100	4	255	32,0	157,2	8	22	200,0	11,8
125	5	280	35,0	185,7	8	22	235,0	15,5
150	6	320	37,0	215,9	12	22	270,0	21,3
200	8	380	41,5	269,9	12	26	330,0	35,2
250	10	445	48,0	323,8	16	30	387,5	67
300	12	520	51,0	381,0	16	33	451,0	82
350	14	585	54,0	412,8	20	33	514,5	106
400	16	650	57,5	469,9	20	36	571,5	140
450	18	715	60,5	533,4	24	36	628,5	178
500	20	775	63,5	584,2	24	36	686,0	223
600	24	915	70,0	692,2	24	42	813,0	345

Blind class 300 raised face

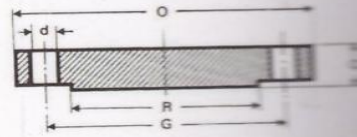

DN 15 a 600
NPS 1/2 to 24

ANSI B 16-5

Diametro Size		O	C	R	Foratura Drilling			Peso Weight
DN	NPS	mm	mm	mm	Numero Number	d mm	G mm	Kg
15	1/2	95	14,5	34,9	4	16	66,5	0,7
20	3/4	120	16,0	42,9	4	20	82,5	1,2
25	1	125	17,5	50,8	4	20	89,0	1,5
32	1 1/4	135	21,0	63,5	4	20	98,5	2
40	1 1/2	155	22,5	73,0	4	22	114,5	3,2
50	2	165	25,5	92,1	8	20	127,0	4,3
65	2 1/2	190	29,0	104,8	8	22	149,0	6
80	3	210	32,0	127,0	8	22	168,5	8
-	3 1/2	230	35,0	139,7	8	26	184,0	10,5
100	4	275	38,5	157,2	8	26	216,0	18
125	5	330	44,5	185,7	8	30	267,0	29
150	6	355	48,0	215,9	12	30	292,0	36
200	8	420	55,5	269,9	12	33	349,0	58
250	10	510	63,5	323,8	16	36	432,0	98
300	12	560	66,5	381,0	20	36	489,0	125
350	14	605	70,0	412,8	20	39	527,0	151
400	16	685	76,5	469,9	20	42	603,0	215
450	18	745	83,0	533,4	20	45	654,0	275
500	20	815	89,0	584,2	24	45	724,0	350
600	24	940	102,0	692,2	24	52	838,0	532

Blind class 600 raised face

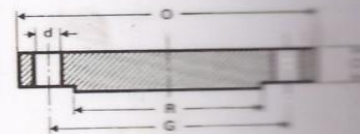

DN 15 a 600
NPS 1/2 to 24

ANSI B 16-5

FLANGES

Tamaño DN	C	C	R	Foratura Drilling			Peso Weight
				Numero Number	d mm	G mm	Kg
15	138	32,5	34,9	4	22	82,5	1,8
20	150	35,5	42,9	4	22	89,0	2,4
25	162	38,5	50,9	4	26	101,5	3,6
30	174	41,5	58,9	4	26	111,0	4,1
40	210	51,5	73,9	4	30	124,0	5,8
50	255	61,5	92,9	8	26	165,0	10,1
60	300	71,5	104,9	8	30	190,5	14
75	360	81,5	127,9	8	26	190,5	13,1
90	420	91,5	157,2	8	33	235,0	22,1
100	450	91,5	165,7	8	36	279,5	36,5
125	540	101,5	215,9	12	33	317,5	47,4
150	630	111,5	265,9	12	39	393,5	82,5
175	720	121,5	323,9	16	39	470,0	123
200	810	131,5	381,9	20	39	533,5	174
225	900	141,5	412,9	20	42	559,0	206
250	990	151,5	469,9	20	45	616,0	259
275	1080	161,5	533,4	20	52	686,0	367
300	1170	171,5	584,2	20	56	749,5	463
350	1410	191,5	692,2	20	68	901,5	875

DN 15 a 600
NPS 1/2 to 24
ANSI B 16-5

Blind class 900 raised face

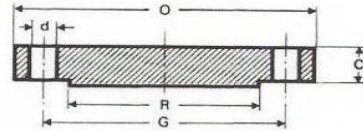

Tamaño DN	C	C	R	Foratura Drilling			Peso Weight
				Numero Number	d mm	G mm	Kg
15	138	32,5	34,9	4	22	82,5	1,8
20	150	35,5	42,9	4	22	89,0	2,4
25	162	38,5	50,9	4	26	101,5	3,6
30	174	41,5	58,9	4	26	111,0	4,1
40	210	51,5	73,9	4	30	124,0	5,8
50	255	61,5	92,9	8	26	165,0	10
60	300	71,5	104,9	8	30	190,5	14
75	360	81,5	127,9	8	33	203,0	19
90	420	91,5	157,2	8	36	241,5	30
100	450	91,5	165,7	8	42	292,0	58
125	540	101,5	215,9	12	39	317,5	72
150	630	111,5	265,9	12	45	393,5	122
175	720	121,5	323,9	12	52	482,5	210
200	810	131,5	381,9	16	56	571,5	315
225	900	141,5	412,9	16	60	635,5	
250	990	151,5	469,9	16	68	705,0	
275	1080	161,5	533,4	16	76	774,5	
300	1170	171,5	584,2	16	80	832,0	
350	1410	191,5	692,2	16	94	990,5	

DN 15 a 600
NPS 1/2 to 24
ANSI B 16-5

Blind class 1500 raised face

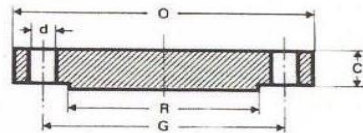

Tamaño DN	C	C	R	Foratura Drilling			Peso Weight
				Numero Number	d mm	G mm	Kg
15	138	32,5	34,9	4	22	89,0	
20	150	32,5	32,9	4	22	95,0	
25	162	35,5	50,9	4	26	108,0	
30	174	38,5	60,9	4	30	130,0	
40	210	44,5	73,0	4	33	146,0	
50	255	51,5	92,1	8	30	171,5	
60	300	57,5	104,8	8	33	197,0	
75	360	67,5	127,0	8	36	228,5	
90	420	75,5	157,2	8	42	263,0	
100	450	82,5	165,7	8	48	324,0	
125	540	108,0	215,9	8	56	368,5	
150	630	127,0	269,9	12	56	438,0	
175	720	145,5	323,9	12	68	539,5	
200	810	164,5	381,0	12	76	619,0	

DN 15 a 300
NPS 1/2 to 12
ANSI B 16-5

Blind class 2500 raised face

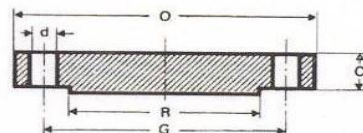

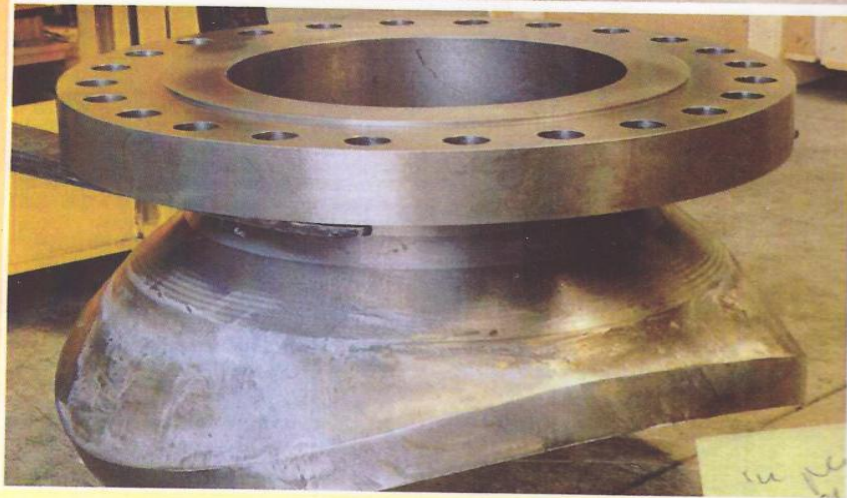
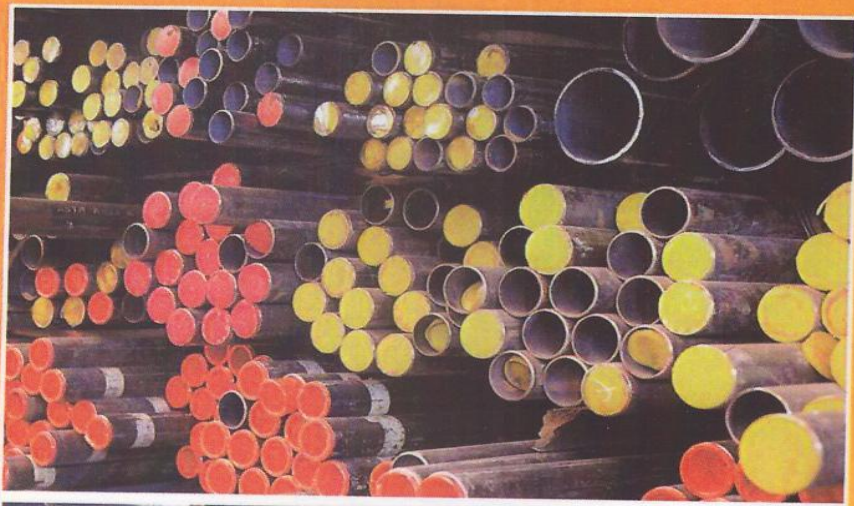

FITTINGS

WELDING FITTINGS

MATERIALS	CARBON STEEL	ASTM A 234 WPB
	ALLOY STEEL	ASTM A234 WP1 - WP11 - WP22 - WP5
	STEEL FOR LOW TEMPERATURE SERVICE	ASTM A420 WPL6 - WPL3
	STAINLESS STEEL	ASTM A403 WP304 - WP304L - WP316 - WP316L - WP321 ASTM A312 TP304 - TP304L - WP316 - WP316L - WP321

Elbow DN 1/2" ÷ 48"
W.T. Refer to standard

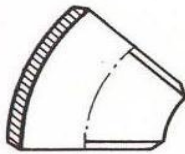

45° long radius
ANSI B16.9

Elbow DN 1/2" ÷ 48"
W.T. Refer to standard

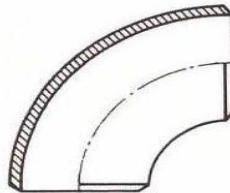

90° short radius B16.28
90° long radius B16.9

Returns DN 1/2" ÷ 24"
W.T. Refer to standard

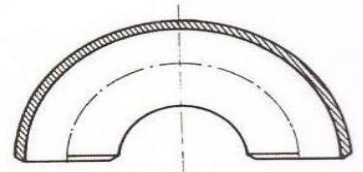

180° short radius B16.28
180° long radius B16.9

Straight tees DN 1/2" ÷ 48"
W.T. Refer to standard

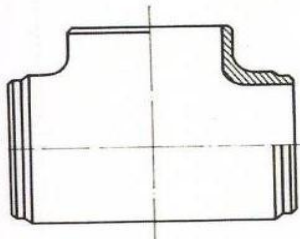

ANSI B16.9

Reducing outlet tees DN 1/2" ÷ 48"
W.T. Refer to standard

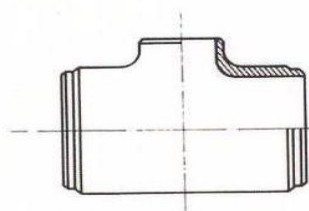

ANSI B16.9

Caps DN 1/2" ÷ 48"
W.T. Refer to standard

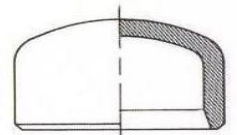

ANSI B16.9

Concentric reducer DN 1/2" ÷ 48"
W.T. Refer to standard

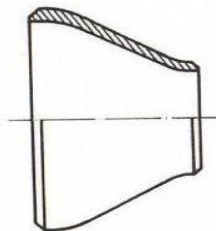

ANSI B16.9

Eccentric reducer DN 1/2" ÷ 48"
W.T. Refer to standard

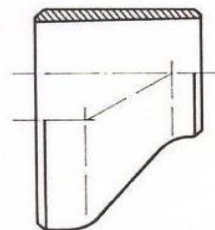

ANSI B16.9

FORGED FITTINGS CLASS 3000 LB – 6000 LB

MATERIALS	CARBON STEEL	ASTM A 105 - A350 LF1
	ALLOY STEEL	ASTM A350 LF3 - A182 F5A - A182 F11 - A182 F22
	STAINLESS STEEL	ASTM A182 F304 L - F316 L - F321 - F347

90° Street elbows
DN 1/4" ÷ 2"

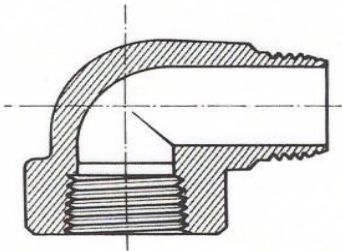

Thread acc.to
ANSI B.21

Elbow 90°
DN 1/4" ÷ 4"

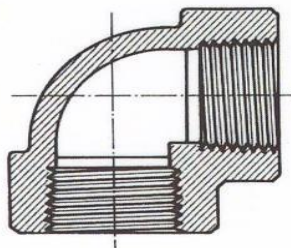

Dimensions according to ANSI B16.11
Thread according to B.2-1

Elbow 45°
DN 1/4" ÷ 4"

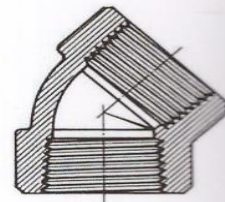

Dimensions according to ANSI B16.11
Thread according to B.2.1.

Tee
DN 1/4" ÷ 4"

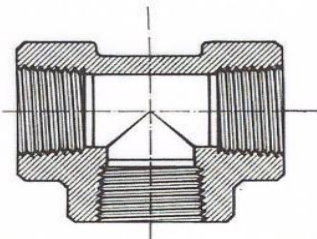

Dimensions according to ANSI B16.11
Thread according to B.2.1

Coupling
DN 1/4" ÷ 4"

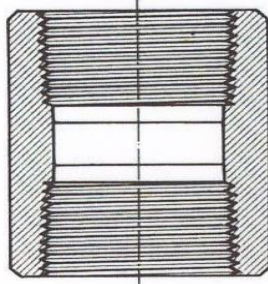

Dimensions according to ANSI B16.11
Thread according to B.2.1

Hexagonal nipples
DN 1/4" ÷ 4"

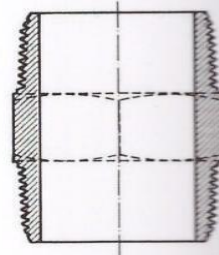

Thread according to B.2.1

Cross
DN 1/4" ÷ 4"

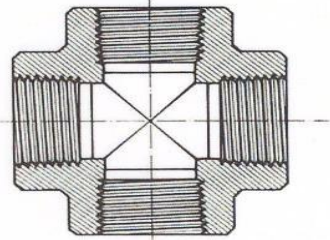

Dimensions according to ANSI B16.11
Thread according to B.2.1

Half coupling
DN 1/4" ÷ 4"

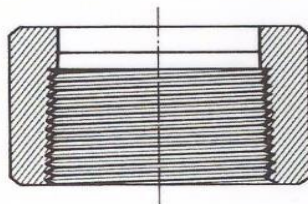

Dimensions according to ANSI B16.11
Thread according to B.2.1

Reducing coupling
DN 3/8" ÷ 4"

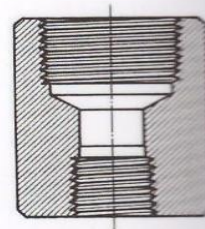

Same dimensions as for couplings
Thread according to B.2.1

FORGED FITTINGS CLASS 3000 LB – 6000 LB

	ASTM A 105 - A350 LF1
	ASTM A350 LF3 - A182 F5A - A182 F11 - A182 F22
	ASTM A182 F304 L - F316 L - F321 - F347

Male-female unions
DN 1/4" ÷ 4"

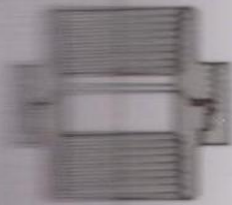

Dimensions according to ANSI B.2.1

Male-female unions
DN 1/4" ÷ 2"

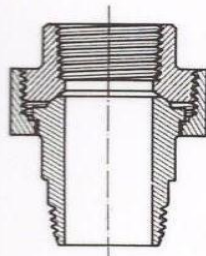

Thread according to ANSI B.2.1

Reducing hexagonal nipples
DN 3/8" ÷ 4"

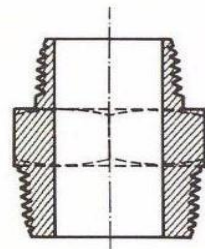

Thread according to ANSI B.2.1

Swedge nipples
DN 1/2" ÷ 4"



Dimensions according to ANSI B.2.1

Female-male reducer
DN 3/8" ÷ 4"

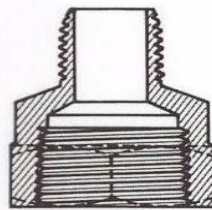

Thread according to ANSI B.2.1

Hexagonal head bushings
DN 3/8" ÷ 4"

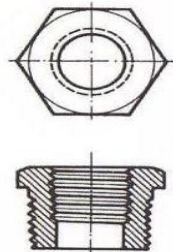

Dimensions according to ANSI B16.11
Thread according to B.2.1

Hexagonal head plugs
DN 1/4" ÷ 4"

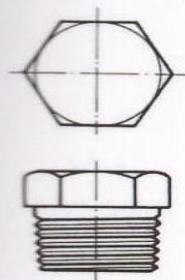

Dimensions according to ANSI B16.11
Thread according to B.2.1

Caps
DN 1/4" ÷ 4"

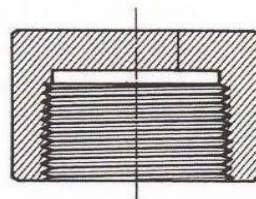

Dimensions according to ANSI B16.11
Thread according to B.2.1

SOCKET WELDING FITTINGS CLASS 3000 - 6000

MATERIALS	CARBON STEEL	ASTM A 105 - A350 LF1
	ALLOY STEEL	ASTM A350 LF3 - A182 F5A - A182 F11 - A182 F22
	STAINLESS STEEL	ASTM A182 F304 L - F316 L - F321 - F347

Elbow 90°
 $\text{Ø } \frac{1}{4}'' \div 4''$

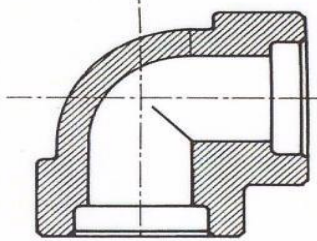

Socket welding end and
 Dimensions according to ANSI B16.11

Tees
 $\text{Ø } \frac{1}{4}'' \div 4''$

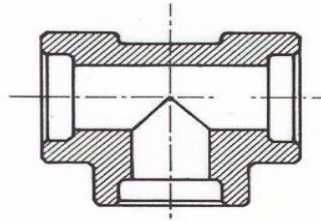

Socket welding end and
 Dimensions according to ANSI B16.11

Coupling
 $\text{DN } \frac{1}{4}'' \div 4''$

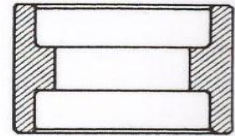

Socket welding end and
 Dimensions according to ANSI B16.11

Elbow 45°
 $\text{Ø } \frac{1}{4}'' \div 4''$

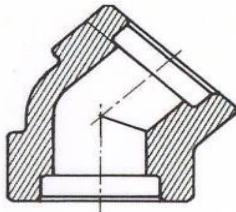

Socket welding end and
 Dimensions according to ANSI B16.11

Cross
 $\text{Ø } \frac{1}{4}'' \div 4''$

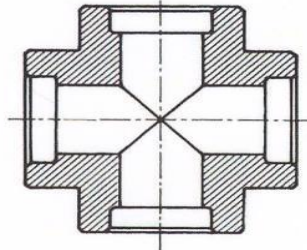

Socket welding end and
 Dimensions according to ANSI B16.11

Half coupling
 $\text{DN } \frac{1}{4}'' \div 4''$

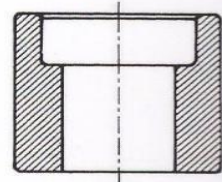

Socket welding end and
 Dimensions according to ANSI B16.11

SOCKET WELDING FITTINGS CLASS 3000 - 6000

MATERIALS	CARBON STEEL	ASTM A 105 - A350 LF1
	ALLOY STEEL	ASTM A350 LF3 - A182 F5A - A182 F11 - A182 F22
	STAINLESS STEEL	ASTM A182 F304 L - F316 L - F321 - F347

Reducing coupling
DN $\frac{3}{8}$ " ÷ 2"

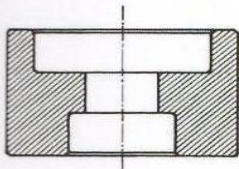

Socket welding end
according to ANSI B.16.11

Cap
DN $\frac{1}{4}$ " ÷ 4"

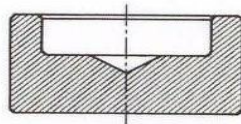

Socket welding end
according to ANSI B.16.11

Union
DN $\frac{1}{4}$ " ÷ 4"

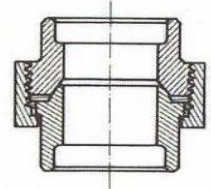

Socket welding end
according to ANSI B.16.11

Nipple outlets
(plain end - threaded end - bevel end)
DN $\frac{1}{2}$ " ÷ 2"

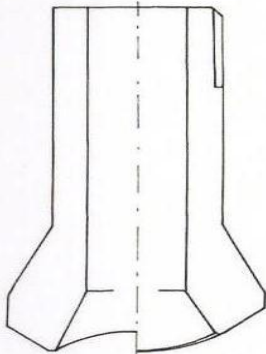

Threaded outlets reducing size
DN $\frac{1}{2}$ " ÷ 4"

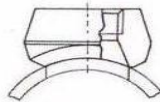

Threaded outlets full size
DN $\frac{1}{2}$ " ÷ 2"

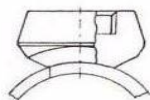

Size on request

Welding bosses
DN $\frac{1}{4}$ " ÷ 2"

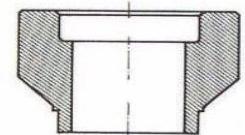
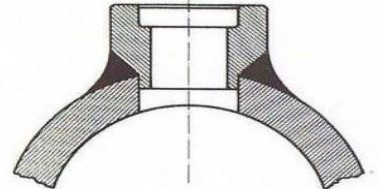

Socket welding end
according to ANSI B.16.11

Welding outlet
(socket outlet)
DN $\frac{1}{2}$ " ÷ 36"

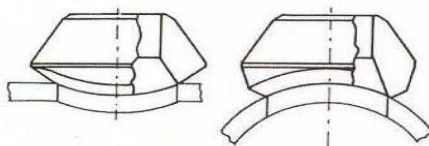

Reducer insert
DN $\frac{1}{2}$ " ÷ 3"

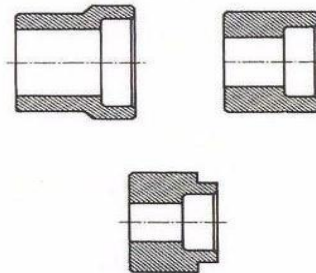

Socket welding end
according to ANSI B.16.11

OTHER EUROGUARCO DIVISIONS:

• Pipes and Tubes

Conforming to ANSI, BWG, AWG, BS and other international standards:

line pipe, boiler pipe, heat-exchanger tube, tube expanders, torque wrenches, condenser tube, boiler and heater tubes, U-tubes, assembly bundle tubes, finned tube for air-cooling systems; Carbon steel, stainless steel, Cu-Ni, admiralty brass, cast iron, special alloys.

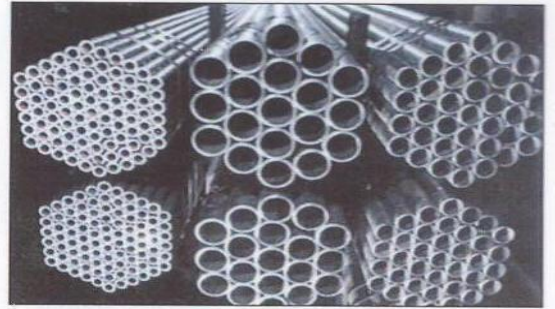

• Valves

Gate, Swing-Check, Globe valves. Ball valves (trunnion, floating, through conduit), wrench and gear operator. Forged and cast steel types. Butterfly, Wafer-type, Diaphragm and Knife-Gate valves. Valves in bronze and brass: gate, globe, swing check and ball type. Conforming to dimensional standards ASME, ANSI, API, BS. Materials: carbon steel, stainless steel, cast iron, ductile iron and alloys. Sizes from 1/4" to 72", depending on the type of valve. Rating from 150 to 2500 Lbs. Supplied with EN 10204 3.1B certificate.



• Gasket and Sealing Products

Conforming to ASME, DIN, EN and BS standards: compressed jointing sheets FASIT®, flexible graphite GRAFLEX®, PTFE based sheets GUAFLON®, mica compound sheets GUARMICA®, gland packings, o-rings, die-cut gaskets, Weaveline gaskets, spiral-wound gaskets, metal-jacketed gaskets, ring-joint gaskets, flat metal gaskets, laminated gaskets, rubber gaskets, cam-profile gaskets, textile gaskets, manhole gaskets, etc.

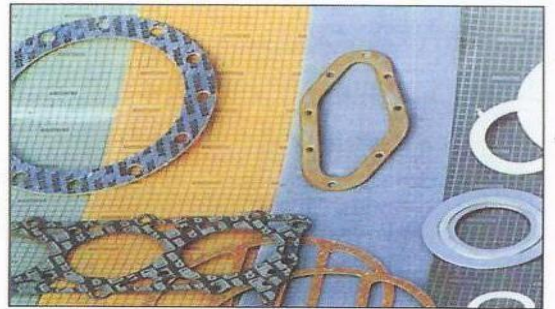

• Insulating and Fire-resistant products

High temperature textiles (fabrics, tapes, ropes, sleeves), insulating blankets, felts, millboards, papers and mouldables, pre-formed insulating jackets, welding blankets, polymeric foam insulating boards, acoustic boards and sound barriers, fire-resistant textiles, compensation joints. Speciality items for marine, oil & gas, steel, glass industries.



 **EUR GUARCO**

Euroguarco S.p.A.

Loc. Pietralba di Arcola, 19021 La Spezia, Italy
Tel. + 39 0187 562611 Fax + 39 0187 562644 - 562955
E-mail: info@euroguarco.com - <http://www.euroguarco.com>